

GEBÄUDEAUTOMATION  
REGELTECHNIK  
SENSORIK

**alre**



**HTRRBd**  
The subtle one.

# GREATLY REDUCED **YET GREAT**



## **THE ELECTRONIC SURFACE\_MOUNTED CONTROLLER FOR MINIMALISTS**

This minimalist thermostat is a sleek and simple device that allows for easy and precise temperature control. The aim was to develop a thermostat with a minimalist aesthetic that features a clean interface reduced to only the essentials. The device is equipped with two seven-segment displays that show the current room temperature and allow the user to set the desired temperature via simple up/down touch sensors. The controller is ideal for those who prefer a minimalist lifestyle, as it takes up little space and seamlessly integrates into any modern decor.

- + Sensor: NTC-internal
- + Switch contact: 1 relay/normally closed
- + 2-digit 7-segment display
- + Control range: 5 °C - 30 °C
- + Valve protection
- + Screw terminals
- + Switching capacity: 3 (0.5) A, 10 actuators
- + Housing pure white (similar to RAL 9010)
- + 13.9 mm Berlin 1000 design
- + Power consumption: < 1W (< 0.5W when display is inactive)



# ROOM TEMPERATURE CONTROLLER ELECTRONIC HTRRBd

## SURFACE-MOUNTED `ULTRA-THIN` - DESIGN BERLIN 1000



### TECHNICAL DATA

<b>Design:</b>	Berlin 1000
<b>Surface finish:</b>	glossy
<b>Housing colour:</b>	pure white, similar to RAL 9010
<b>Housing material:</b>	ABS plastic
<b>Ambient temperature:</b>	0 to 40 °C
<b>Storage temperature:</b>	-20 to +70 °C
<b>Permissible atmospheric humidity:</b>	Max. 95% rel. humidity, non-condensing
<b>Electrical connection:</b>	screw-type terminals
<b>Mounting/attachment:</b>	Surface- / wall-mounting (4-hole assembly on flush-mounted socket)
<b>Protection rating:</b>	IP30
<b>Protection class:</b>	II, if properly mounted
<b>Safety and EMC:</b>	according to DIN EN 60730
<b>Average power consumption:</b>	< 0.5 W
<b>Max. switching current:</b>	3 (0.5) A
<b>Switching element:</b>	relay
<b>Switching contact:</b>	NO contact
<b>Output signal:</b>	switching, 230 VAC, 50 Hz
<b>Sensor:</b>	NTC, internal
<b>Control range:</b>	5 to 30 °C
<b>Display:</b>	2-digit 7-segment display (white)
<b>Hysteresis:</b>	< approx. 0.5 K at a temperature change of max. 4 K/h

### APPLICATION

temperature control and monitoring in offices, homes and hotels, can be connected directly to the valve actuators for hot water heating systems.

Valve actuator: normally closed.  
Up to max. 10 actuators for valves can be connected.

### TYPE/IMAGE

### ITEM NO.

### CIRCUIT DIAGRAM

### EURO/PG

HTRRBd-210.100

MA700800

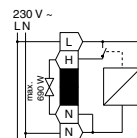

### ACCESSORIES

### ITEM NO.

### FEATURES

### EURO/PG

JZ-21

MN990006

Adapter frame for mounting the room temperature controller on flush-mounted sockets up to 80 x 80 mm



### ILLUSTRATIONS

HTRRBd

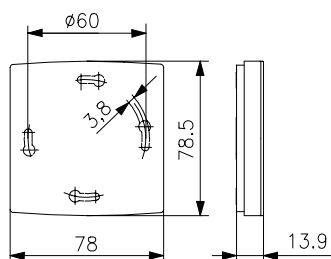



**alre –  
simply control.**

**alre**

**ALRE-IT**

REGELTECHNIK GMBH

Richard-Tauber-Damm 10  
12277 Berlin

Phone: +49(0)30 399 84 0  
Fax: +49(0)30 391 70 05  
Mail: [mail@alre.de](mailto:mail@alre.de)

**[www.alre.de](http://www.alre.de)**